



morton.

Pymont B304/24 Point Street

1 1 1

Ensuring a city fringe lifestyle in the highly desired "Watermark" building, this exceptional residence is the epitome of contemporary designer living located in the prized northern Pymont peninsula. Privately positioned with superb city skyline views, it's quiet and yet just a few minutes stroll to the city centre and village life.

- Immaculately appointed with the finest of finishes
- Impressively proportioned open plan living areas
- Generous media enclave is an ideal study/office
- Awash with the sunlight of a north-eastern aspect
- Deluxe kitchen, granite benches, Smeg gas fixtures
- Spacious master with built-ins, views, balcony access
- Marble bathroom, ducted air conditioning
- New carpet and interior painting throughout
- Ample interior storage, full brick construction
- Secure parking, visitor parking, on-site management
- 25 metre pool, gym and verdant garden surrounds

View

As advertised or by appointment

Agent

James Crow

0410 593 057

james@morton.com.au

morton.com.au

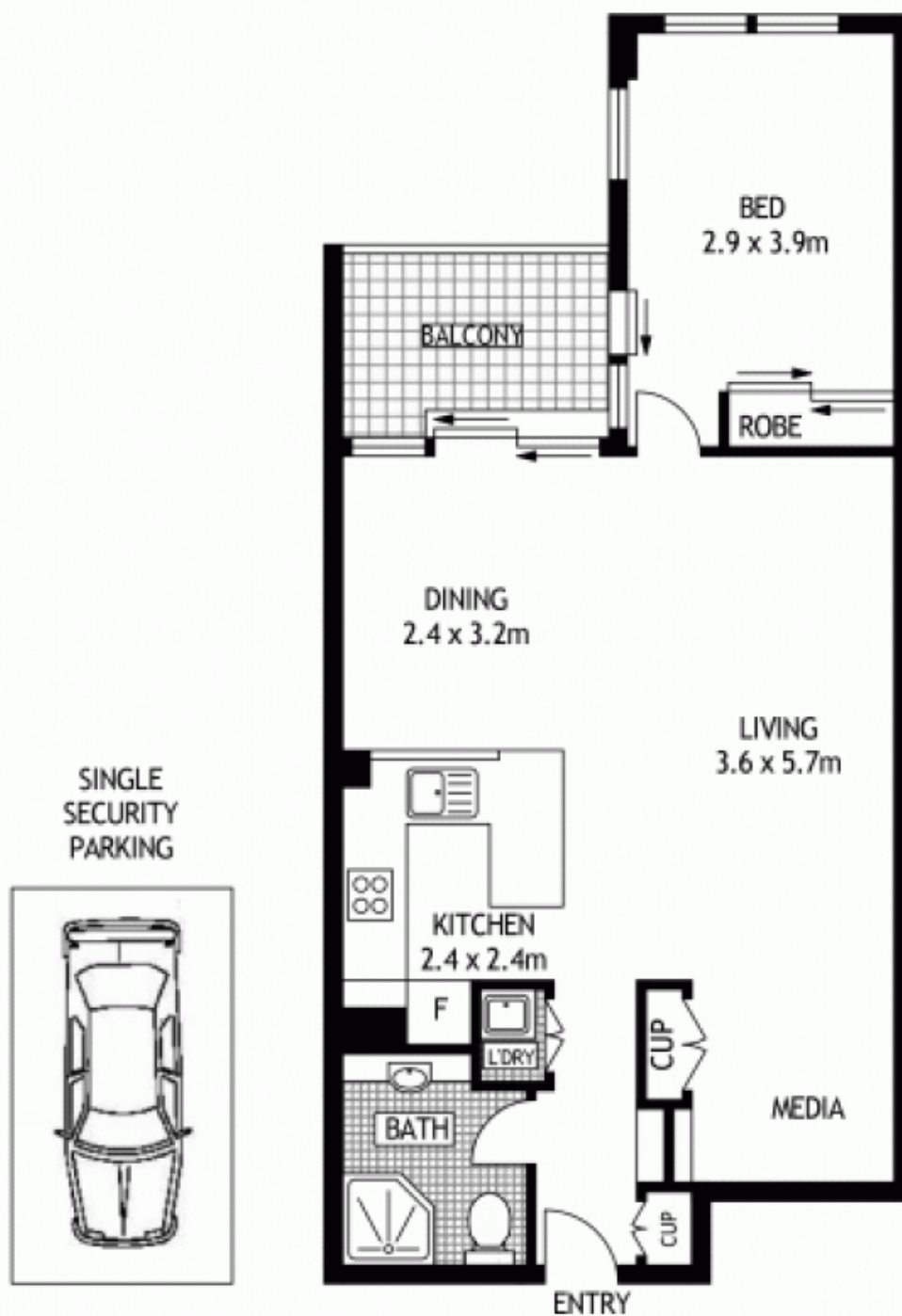

LEVEL ONE

LEVEL THREE

B304/24 POINT STREET

PYRMONT

SCAPE Floor Planing Disclaimer: This floor plan is conceptual only. It is provided for illustrative purposes only and should not be relied upon. We make no guarantees to the correctness of this plan. All interested parties should make and rely on their own enquiries in determining the accuracy of the information contained in this floor plan.