

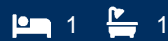

**morton.**

**Woolloomooloo** 238/6 Cowper Wharf Roadway



This luxurious waterfront fully furnished apartment is located on the eastern side of Woolloomooloo's Finger Wharf. With floor to ceiling windows this property makes the most of the stunning views over Potts Point and Garden Island.

- Furnished
- Reverse cycle air conditioning
- Internal laundry with washer and dryer
- Additional internal storage
- Pool and gym available (membership required)
- On-site 24 hour security

**View**

As advertised or by appointment

**Agent**

**Devak Arutla**

📞 0458 788 790

✉️ devak.arutla@morton.com.au

**morton.com.au**

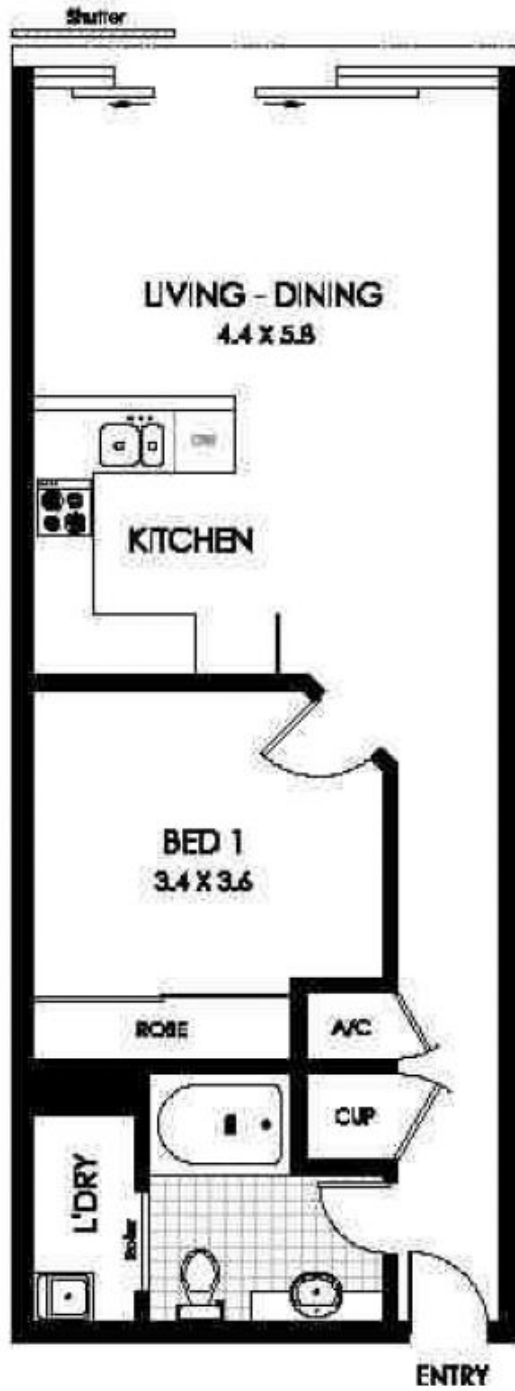

\* note  
all measurements are approximate only.  
Plan is provided only as an indication of layout.

