



morton.

Macquarie Park 1506/13 Halifax Street



Convenience, space and premium lifestyle in the high-rise building Nexus at NBH Lachlan's Line in Macquarie Park. This designer property with low- maintenance and high yield is great buying opportunity for young professionals and investors.

- Spacious open plan design with timber floorboards
- Quality designer kitchen with Smeg gas appliances
- Video intercom, laundry with dryer, air-conditioning, NBN internet
- Lush landscaped gardens, pool, & BBQ, onsite building manager
- Easy walking distance to bus services and North Ryde Station
- Pet friendly building

View

As advertised or by appointment

Agents

Vivian Zhang

☎ 0447 964 200
✉ vivian@morton.com.au

Dylan Choe

☎ 0416 932 977
✉ dylanchoe@morton.com.au

morton.com.au

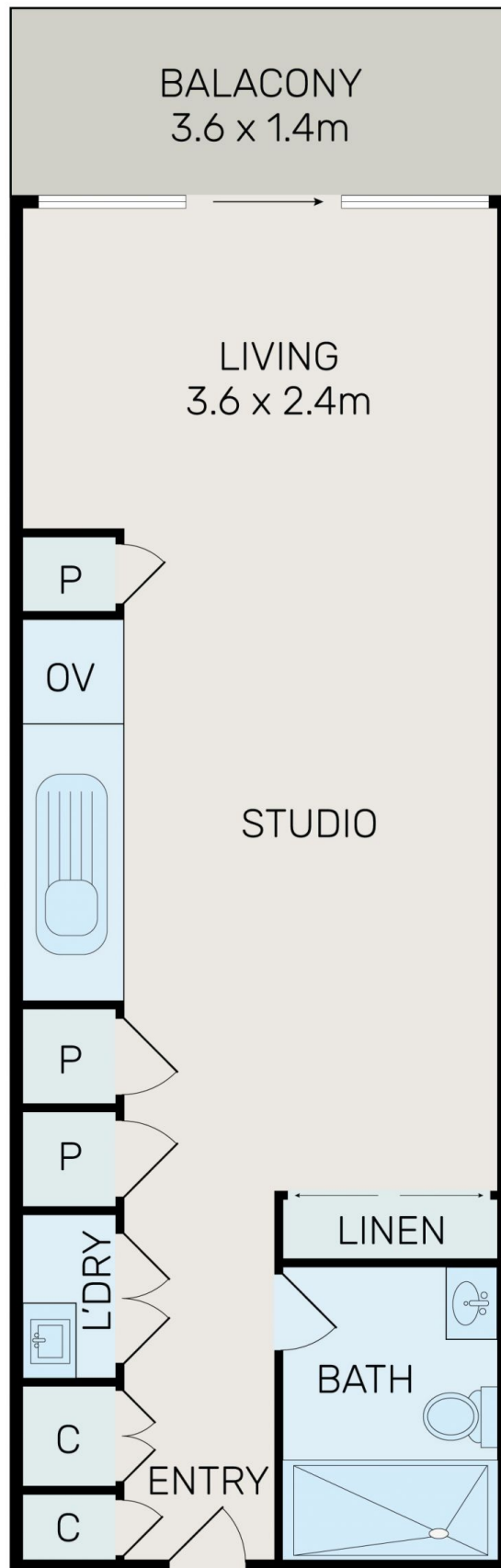

All information contained herein is gathered from all sources we believe to be reliable. However we cannot guarantee its accuracy and interested parties should rely on their own enquiries.

1506/13 Halifax Street, Macquarie Park