



# morton.

**Waterloo** 205/9 Archibald Avenue

 1  1

This modern, stylish one bedroom apartment located on level 2 of the highly sought-after Rise development, Waterloo's most centrally located state-of-the-art residential complex. With open plan living flowing onto a spacious poolside balcony, and lots of natural light.

Rise residents are further spoiled with full access to a range of resort style facilities including a heated outdoor pool with cabana lounges, fitness centre, picnic areas with outdoor BBQs and a pizza oven, and secure internal garden courtyards.

- Quality finishes and appliances throughout
- Open plan living and dining area
- Modern kitchen with stone bench top, dishwasher, and gas cooking
- Large, light-filled master bedroom with built-in wardrobe
- Internal laundry equipped with dryer
- An abundance of storage throughout the apartment
- Very spacious and modern bathroom with walk-in shower

[morton.com.au](http://morton.com.au)

### View

As advertised or by appointment

### Agent

**Emma Ryan**

 0409 325 440

 [emmar@morton.com.au](mailto:emmar@morton.com.au)

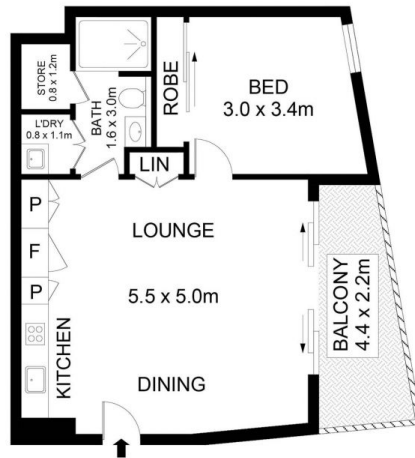

205/9 Archibald Avenue, Waterloo

Disclaimer  
Floor Plan measurements are approximate and are for illustrative purposes only. While we cannot doubt the floor plans accuracy, we make no guarantee, warranty or representation as to the accuracy and completeness of the floor plan.