

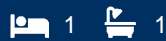

morton.

Alexandria 20/156 Botany Road



This immaculately presented 'Alexandria Park' apartment promises an ideal modern living experience. Set in a cosmopolitan inner city pocket it's moments to transport, parks, cafes and shops.

- Top floor position
- Generous integrated living/dining zone enjoys outdoor flow
- Glass sliding doors open to balcony overlooking streetscape
- Fantastic setting to spill outdoors while entertaining friends
- Stylish stone top kitchen, dishwasher, Bosch gas appliances
- Large double bedroom with balcony access
- Large tiled bathroom with internal laundry
- Ducted air conditioning, intercom + storage
- Stroll to Alexandria Park and future Waterloo Metro Station

View

As advertised or by appointment

Agent

Alexander Karabanov

📞 0409 896 152

✉️ alexander.karabanov@morton.com.au

morton.com.au

Storage
Cage

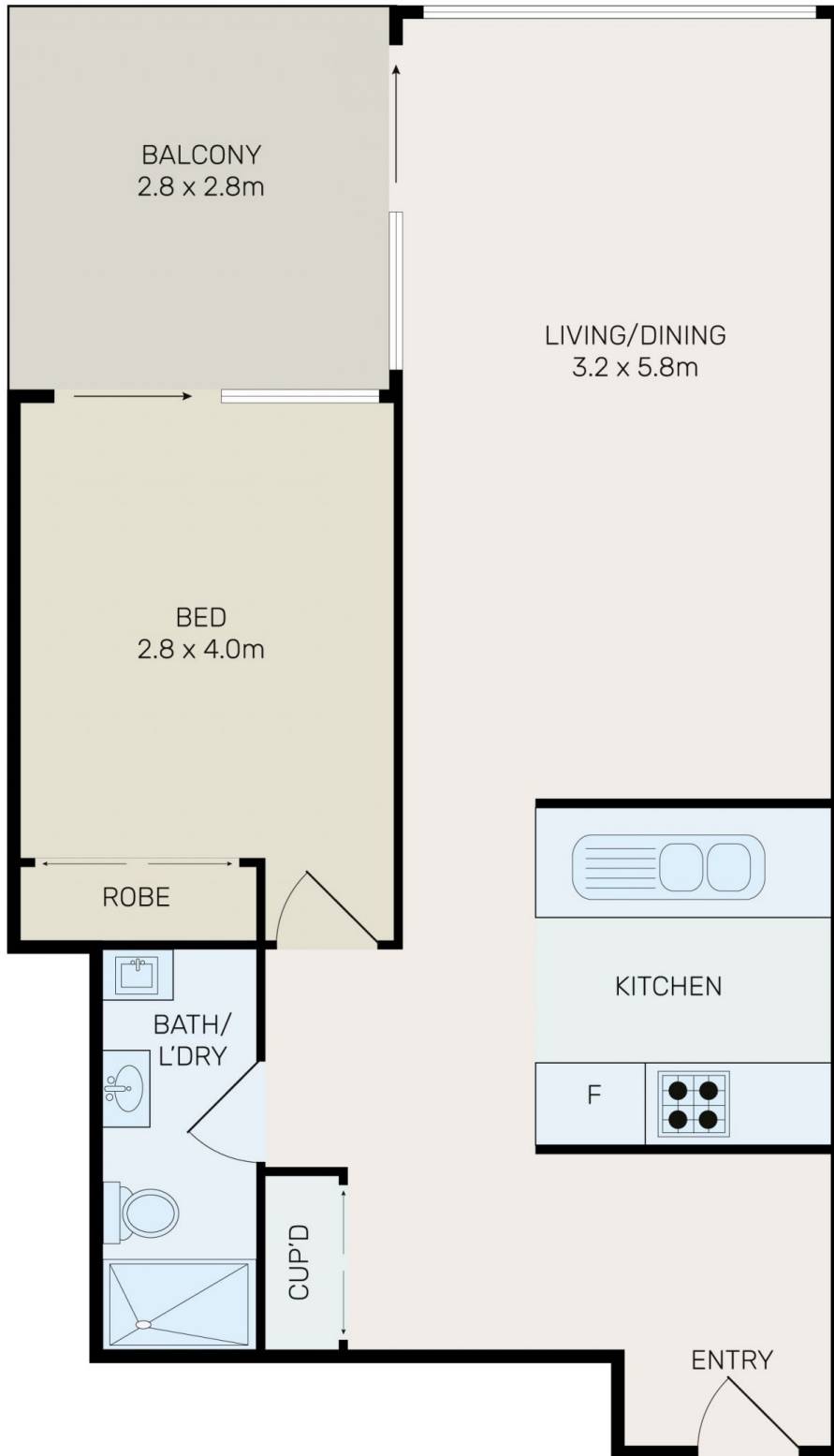

All information contained herein is gathered from all sources we believe to be reliable. However we cannot guarantee its accuracy and interested parties should rely on their own enquiries.



CampaignPROS

morton.

Alexandria 20/156 Botany Road