



# morton.

**Chippendale** E2005/3 Carlton Street

🛏 2 🚿 1 🚗 1

In an award-winning building of unrivalled prestige and global acclaim, this breathtaking apartment defines cutting edge city living. Nestled on the edge of Sydney's CBD, this beautiful apartment is located in the highly sought-after Central Park development.

- Located on the north eastern corner of level 20 with unobstructed views
- Modern, high-end finishes and fixtures throughout
- Open plan living with sleek designer kitchens and bathroom
- Ducted air conditioning, security intercom, internal laundry
- 24-hour concierge, one secure car park space and storage cage
- Access to Central Park Fitness Centre with a pool, gym and spa
- Located above Central Park Mall, convenient for all your shopping requirements
- Exceptional investment property in a sought-after setting
- Stroll to Sydney Uni, UTS, buses/trains, cafes, restaurants

**morton.com.au**

## View

As advertised or by appointment

## Agents

### Calvin Chan

📞 0406 888 028  
✉ calvin@morton.com.au

### Amber Riethmuller

📞 0411 437 673  
✉ amber.riethmuller@morton.com.au

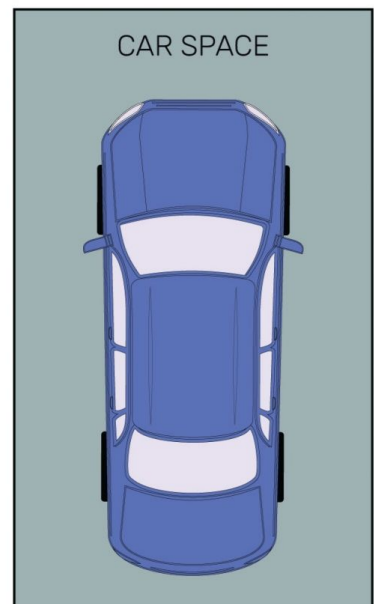
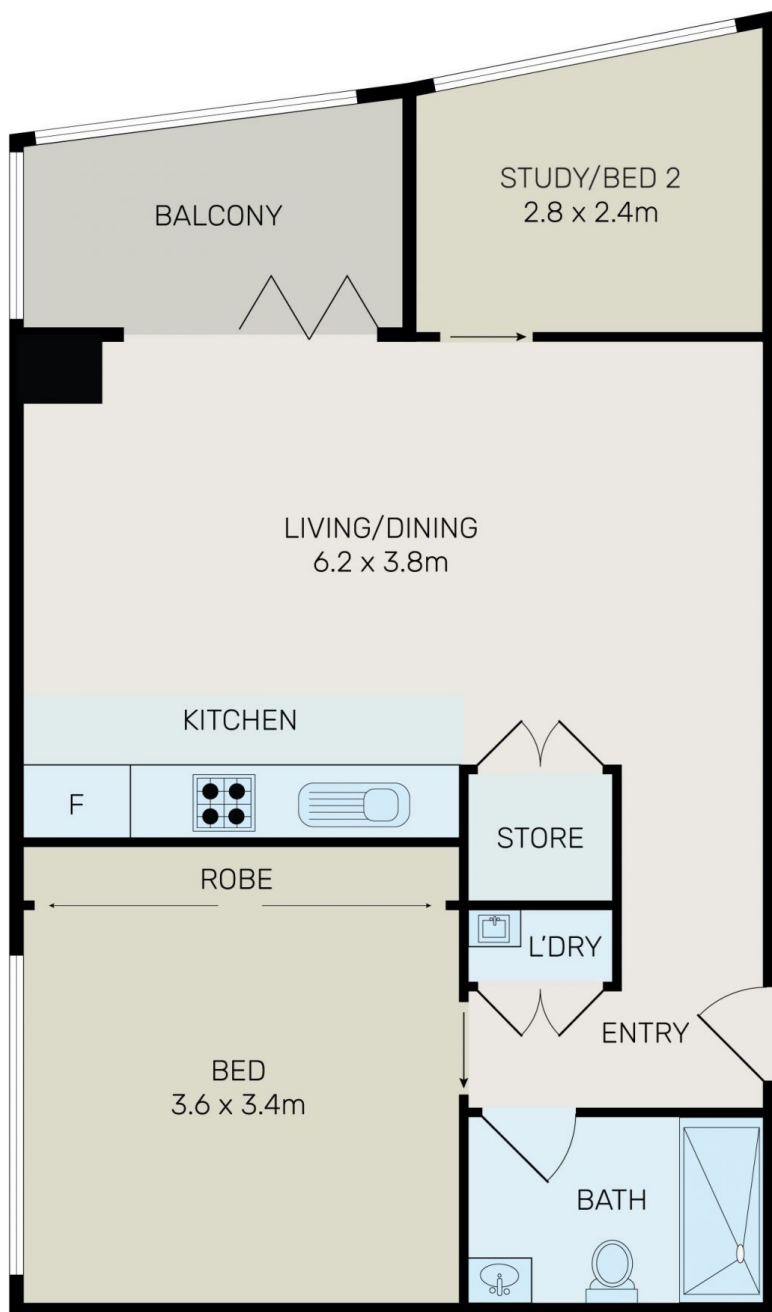

All information contained herein is gathered from all sources we believe to be reliable. However we cannot guarantee its accuracy and interested parties should rely on their own enquiries.



**E2005/3 Carlton Street, Chippendale**