



morton.

Yarramundi 42 Kestrel Way

5 3 3

Nestled within the picturesque Nepean Park Estate, sits this meticulously designed single level home. Privately positioned on an enormous 3058sqm of land you can enjoy a serene and peaceful lifestyle. This wonderful community subdivision boasts a community centre, lagoon, spacious acreage community lots, and bushwalking tracks for your leisure.

View

As advertised or by appointment

Agent

Ian Ahearn

0457 483 610

ian.ahearn@morton.com.au

- Spacious 5-bedroom family home
- Master bedroom with ensuite and walk-in robe
- Expansive, well-equipped kitchen seamlessly connected to a massive open plan family and meals room
- Formal lounge and dining rooms
- Large games/rumpus room
- Ducted air conditioning throughout
- Brilliant gazebo area overlooking an oversized saltwater pool
- Separate self-contained studio, perfect for in-law accommodation or a teenagers' retreat
- Heavy duty concrete drive leads to a three-car garage/workshop at the rear of the property
- Backs onto a community park

morton.com.au

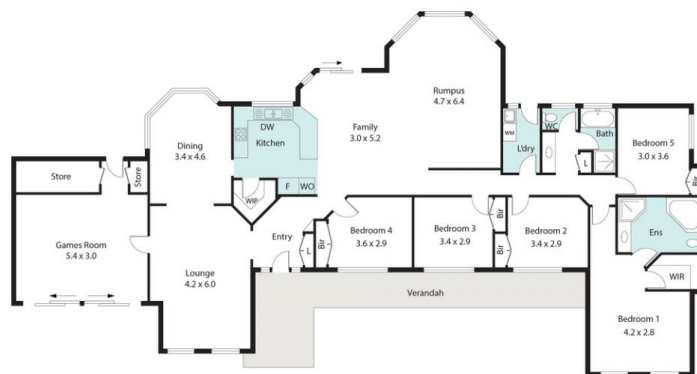
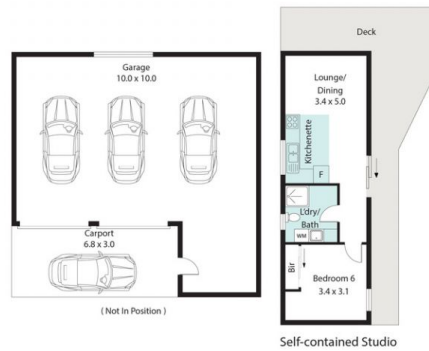

42 Kestrel Way, Yarramundi

morton.

Every care has been taken to verify the accuracy of the details and dimensions in this property plan. Prospective purchasers are advised to make their own enquiries to satisfy themselves in all respects. The plan is a representation only and is not necessarily to scale.