



morton.

Wentworth Point 185/33 Hill Road

 2  2  1

The Waterfront is located moments to Sydney Olympic Park main venues, train station, Bicentennial Park and Millennium Parklands. Located in Palermo, this is your opportunity to move into this freshly painted two bedroom apartment with courtyard, only a short stroll from The Promenade and The Piazza.

- Located on the ground floor with a large courtyard
- Combined living and dining room
- Reverse cycle air conditioning
- Full size kitchen with stainless steel appliances
- Gas cooking and lots of cupboard space
- Great size bedroom with huge built-in wardrobes
- Great size study room
- Laundry room with clothes dryer
- Secure undercover single car space and storage cage
- NBN and Foxtel outlets ready for account connection
- On-site building manager.
- Palermo building includes exclusive pool and gym

View

As advertised or by appointment

Agents

Zarin Hossain

 0418 328 479

 zarin.hossain@morton.com.au

Nevena Tsahtarlis

 0428 835 910

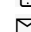
 nevena@morton.com.au

morton.com.au



ENTRY	1
LIVING	2
DINING	3
KITCHEN	4
MAIN BEDROOM	5
ENSUITE	6
LAUNDRY	7
BATHROOM	8
ENCLOSED MEDIA	9
LINEN	10
BEDROOM 2	11
TERRACE	12
CLOTHES DRYING	13

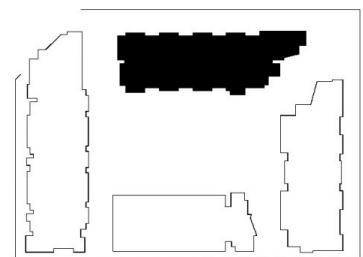

LEVEL 01

PALERMO

UNIT: **185**

TYPE: 2 Bedroom

UNIT AREA: 92.0 sqm

OUTDOOR AREA: 110.0 sqm



Disclaimer: All layouts are indicative only, and subject to change.

