



morton.

Riverwood 510/1 Vermont Crescent

🛏 2 🚿 2 🚗 1

Nestled in the vibrant Washington Park precinct with sun-filled interiors throughout. Newly painted walls and new carpeting in the lounge and study areas. Enjoy the added luxury of an ensuite in the master bedroom, and the flexibility of open-plan living.

Features include:

- ? Internal laundry facilities
- ? Sleek modern kitchen with high-quality appliances
- ? Reverse cycle air conditioning for year-round comfort
- ? Two bedrooms with built-in wardrobes
- ? Master bedroom with ensuite
- ? Additional study room
- ? Secure basement parking

Enjoy the convenience of being within walking distance to a diverse range of shopping options including Aldi, Woolworths, cafes, restaurants, and a post office, all located just 1 km away at the local shopping centre. The Morris Lemma Sports

View

As advertised or by appointment

Agent

Nada Fayad

📞 0408 376 995

✉ nadaf@morton.com.au

morton.com.au



1300 111 088
www.washingtonpark.com.au

Proudly developed by
PAYCE

Disclaimer: This floor plan has been prepared for marketing purposes only. All descriptions, dimensions, depictions and other details in this floor plan may not be to scale and may vary from the property as built. Your attention is drawn to the special conditions of the contract for sale of land. No third party has any authority to make or give any representation or warranty in relation to the property unless the representation or warranty is confirmed by Payce Communities No.2 Pty Limited and included in the contract for sale of land. [Rev A. 24.07.13]



APARTMENT 510 LOT 77 2BED + STUDY

Internal	77m ²
External	11m ²
Total	88m²

FAIRMOUNT

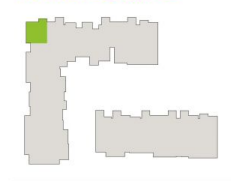

We are
Washington Park.