



morton.

Woolloomooloo 9/57 Cowper Wharf Roadway



Quietly located in a sought after modern security block. Opposite Woolloomooloo Bay and the iconic Finger Wharf, this light filled studio apartment enjoys views of leafy treetops and the shimmering Potts Point suburb. This harbourside apartment is footsteps from trendy cafes, bars, restaurants and convenience stores, and a short stroll to Potts Point shops, the Botanic Gardens and Sydney CBD. It's perfect for an investor, someone looking to enjoy the inner city living.

- Spacious open plan living with balcony
- Modern kitchen with dishwasher
- Timber flooring
- Simple functionality with good storage space
- Internal laundry
- Clean bathroom with bath tub
- Security building with intercom
- Ceiling fans
- Across the road from the harbour and Woolloomooloo eateries

View

As advertised or by appointment

Agent

Alexander Karabanov

📞 0409 896 152

✉️ alexander.karabanov@morton.com.au

morton.com.au

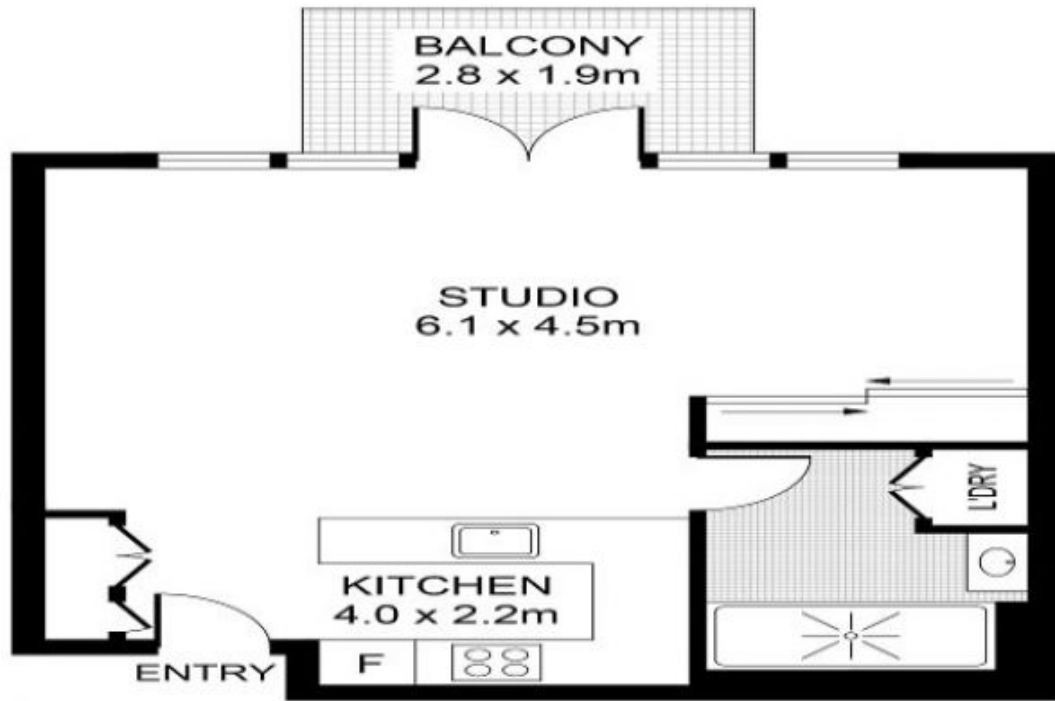

9/57 Cowper Wharf Rd
WOOLLOOMOOLOO

PLANS SHOWN ONLY INDICATIVE OF LAYOUT. DIMENSIONS ARE APPROXIMATE.

Nov 19

