



# morton.

**Sydney** 9.2/2 Phillip Street

🛏 2 🚿 2 🚗 1

A flowing interior design, quality and style define this deluxe 'The Quay' residence where premium finishes, great natural light and breathtaking Sydney panoramas all combine to create a sensational lifestyle apartment. It features an impressive single-level layout and an uplifting sense of space along with a prime position in an iconic building while being supremely well-located on the doorstep of Sydney's harbourfront entertainment precinct.

- Superb northerly views over Circular Quay and the Harbour Bridge
- Large picture windows maximise amazing vistas and natural light
- Generous and bright layout with open-plan lounge and dining areas
- Two peaceful bedrooms include a main with marble tiled ensuite
- Quality kitchen features a breakfast island and integrated appliances
- World-class fitness centre with pool, sauna, spa and squash

### Auction

Saturday, 11 May 2024, 11:15 am

### View

As advertised or by appointment

### Agents

#### Ettiene West

📞 0410 593 749

✉ ettiene@morton.com.au

#### Arman Zounuzu

📞 0410 539 793

✉ arman.zounuzu@morton.com.au

[morton.com.au](https://morton.com.au)

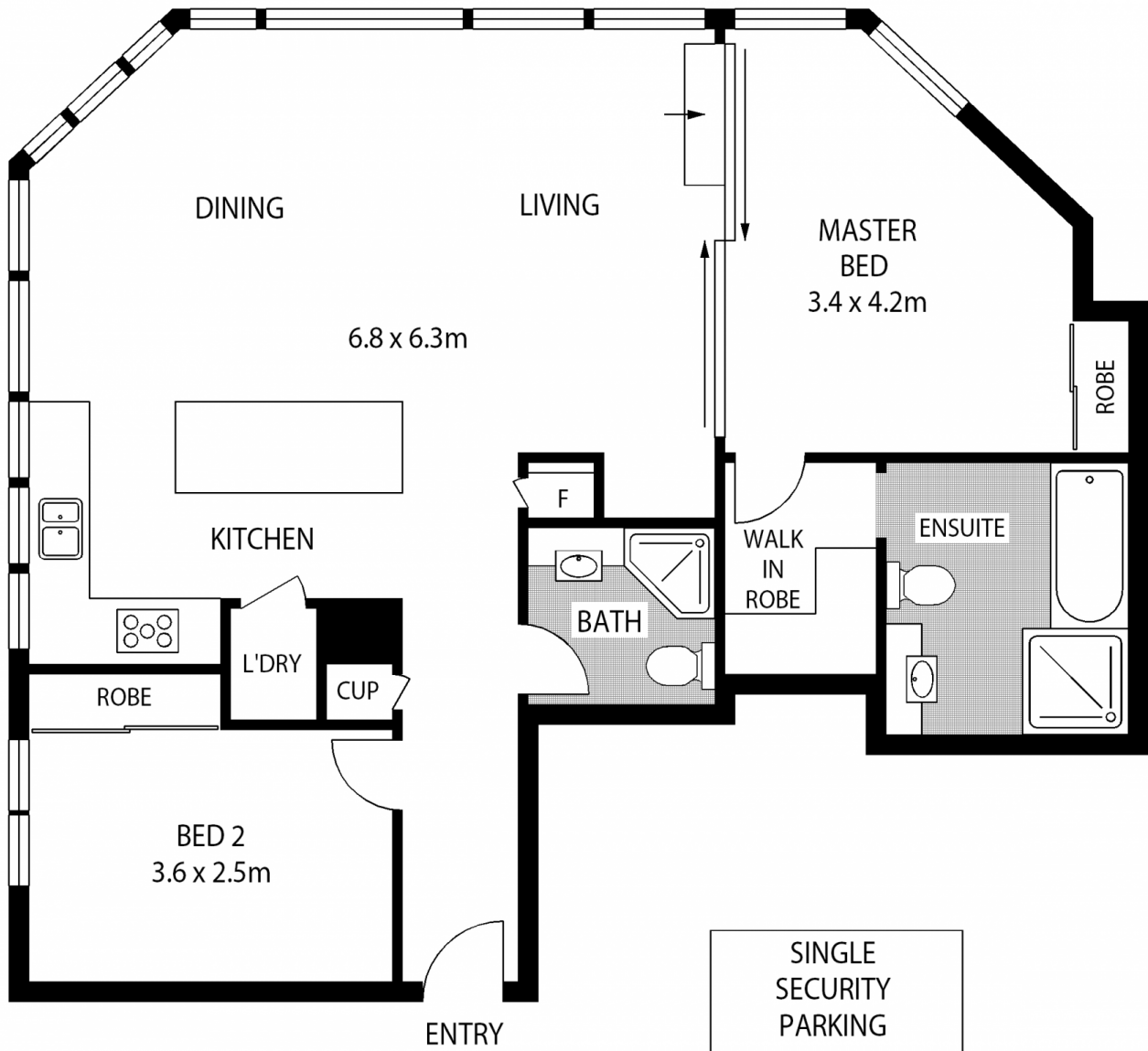

**LEVEL 9**

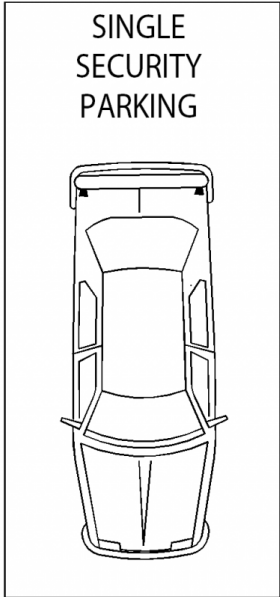

**9.2/2 PHILLIP STREET**

**SYDNEY**

SCAPE Floor Planning Disclaimer: This floor plan is conceptual only. It is provided for illustrative purposes only and should not be relied upon. We make no guarantee as to the correctness of this plan. All interested parties should make and rely on their own enquiries in determining the accuracy of the information contained in this floor plan.