

morton.

Wentworth Point B730/1 Burroway Road

 2  2  1

Located in the highly sought after Jewel development - your opportunity to move into this luxurious two bedroom waterfront residence offering lifestyle, comfort and convenience, boasting an east-facing alfresco entertainer's balcony.



- Open living and dining areas leading directly to 15sqm east-facing entertainer's balcony
- Quality hard flooring throughout living areas
- Fully equipped gas kitchen with premium appliances & stone bench tops
- Spacious bedrooms each with built in wardrobes
- Separate study nook, ideal for working from home
- Split system reverse cycle air conditioning
- Internal laundry with dryer
- Audio-visual intercom with security and lift access
- Secure basement parking and storage cage
- Communal landscaped courtyard with BBQ facilities

View



As advertised or by appointment

Agents

Zarin Hossain

 0418 328 479
 zarin.hossain@morton.com.au

Nevena Tsahtarlis

 0428 835 910
 nevena@morton.com.au

morton.com.au



GOLD SCREEN FACADE



7 N

JOINTLY DEVELOPED BY



Disclaimer: This floor plan has been prepared for marketing purposes only. All descriptions, dimensions, depictions and other details in this floor plan may not be to scale and may vary from the property as built. Your attention is drawn to the special conditions of the contract for sale of land. No third party has any authority to make or give any representation or warranty in relation to the property unless the representation or warranty is authorised by Payce Communications Werworth Point Pty Ltd. (PWT Development Pty Ltd) and included in the contract for sale of land. 50/95 Disclaimer: In this disclaimer, Developer means Payce Communications Werworth Point Pty Ltd ACN 168 430 746 and SH Development Pty Ltd ACN 164 28 145. Development means the retail and residential development at 1 Burroway Road, Werworth Point known as Jewel 50/95 means Sydney Olympic Park Authority, a statutory body constituted under the Sydney Olympic Park Authority Act 2002 (NSW). The Developer is responsible for all matters in connection with understanding and completing all of the works required to be performed or carried out to complete the Development and SOPA has no responsibility or involvement in those matters.

SALES BY



(Rev C_01/06/15)

JEWEL

WENTWORTH POINT

APARTMENT 730

LOT 140
2BED + STUDY

Internal	80 sqm
External	13 sqm
Total	93 sqm

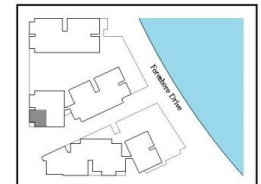

LEVEL 7

JEWEL DISPLAY CENTRE
1 Burroway Road, Wentworth Point 2127
1300 888 778 | jewelresidences.com.au