



morton.

Wentworth Point 609/8 Baywater Drive

 2  2  1

The Waterfront is located moments to Sydney Olympic Park's main venues, train station, Bicentennial Park and Millennium Parklands. Located in Messina, this is your opportunity to move into this two bedroom apartment, only a short stroll from The Promenade and The Piazza.

- Large wrap around balcony perfect for entertaining
- Large floorplan 114sqm total area size
- Combined open plan living and dining
- Air conditioning in the lounge room
- Corner position apartment excellent source of natural light and ventilation
- Gas cooking and quality finishes throughout
- Family size bedrooms with built-in wardrobes
- Laundry room and clothes dryer
- Single car space and storage cage

View

As advertised or by appointment

Agents

Zarin Hossain

 0418 328 479

 zarin.hossain@morton.com.au

Nevena Tsahtarlis

 0428 835 910

 nevena@morton.com.au

morton.com.au

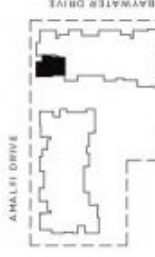

MARINE PARADE

LOCATION

UNIT 609
2 BEDROOM

INTERNAL 85 sqm
BALCONY 29 sqm
TOTAL AREA 114 sqm

KEY:

- 1 Entry
- 2 Living
- 3 Dining
- 4 Kitchen
- 5 Bedroom 1
- 6 Bedroom 2
- 7 Wardrobe
- 8 Bathroom
- 9 Ensuite
- 10 Laundry
- 11 Store
- 12 Balcony

28.10.2010
REV. D

