



morton.

Epping 3/1 Maida Road



Perfectly situated on a corner plot within the meticulously maintained 'Rosewood' complex, this ground-floor apartment enjoys an elevated position and showcases luminous living spaces. Positioned to the East, it offers convenient access to an array of amenities.

- Impeccably presented interiors flooded with natural light
- Open-plan lounge and dining area featuring a bay window seamlessly extending to the balcony
- Timber flooring throughout
- Generously proportioned bedroom complete with built-in wardrobes
- Well-appointed kitchen boasting a verdant vista
- Expansive bathroom featuring a separate bath and shower
- Internal laundry facilities provided
- Single lock-up garage for secure parking

View

As advertised or by appointment

Agents

Dylan Choe

☎ 0416 932 977
✉ dylanchoe@morton.com.au

Vivian Zhang

☎ 0447 964 200
✉ vivian@morton.com.au

morton.com.au

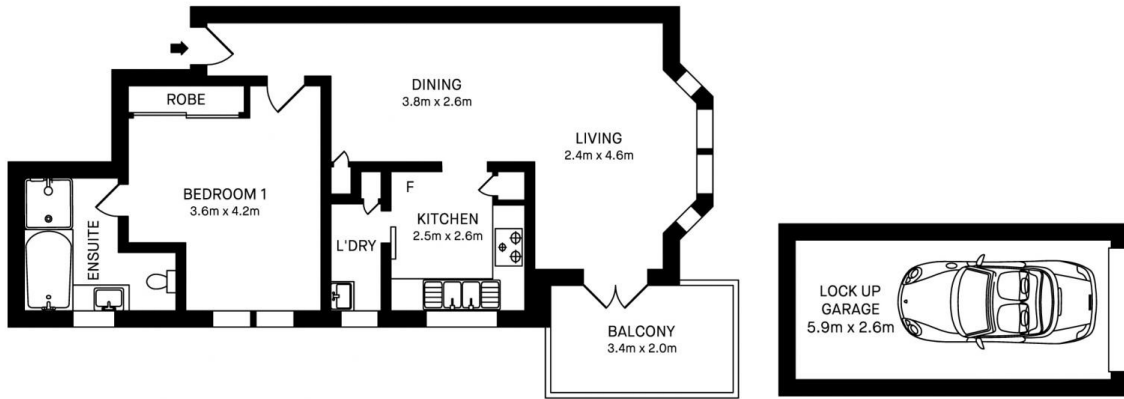

GROUND FLOOR

3/1 MAIDA ROAD, EPPING



Please note these measurements are approximate only. The plans is intended as a rough guide for illustrative purpose. It is not warranted or guaranteed to be correct nor it is part of the sale or rental contract.

