



morton.

Riverwood 410/1 Vermont Crescent

 2  2  1

Located in a sought-after neighbourhood, this property's bright, sun-filled interiors offer the perfect combination of convenience and comfort. overlooking the park and greenery, this property is easy to love.

Property features:

- Spacious bedrooms, both with built-ins
- Well-appointed kitchen, modern appliances and ample storage
- Open plan living and dining flows onto the balcony
- Modern bathrooms, en-suite via main bedroom
- Sun-filled apartment overlooking the park and garden
- Single car space in the lock-up basement
- Study nook

View

As advertised or by appointment

Agent

Nada Fayad

 0408 376 995

 nadaf@morton.com.au

morton.com.au



**APARTMENT 410
LOT 70
2BED + STUDY**

Internal	77m ²
External	11m ²
Total	88m²

FAIRMOUNT

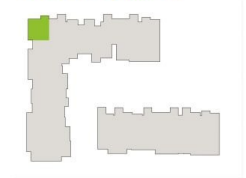

1300 111 088
www.washingtonpark.com.au



Disclaimer: This floor plan has been prepared for marketing purposes only. All descriptions, dimensions, depictions and other details in this floor plan may not be to scale and may vary from the property as built. Your attention is drawn to the special conditions of the contract for sale of land. No third party has any authority to make or give any representation or warranty in relation to the property unless the representation or warranty is confirmed by Payce Communities No.2 Pty Limited and included in the contract for sale of land. [Rev A. 24.07.13]

