



# morton.

**Sydney** 215/27 Park Street



This one-bedroom apartment located on 21st floor offers breathtaking views of the cityscape. Placed in the heart of the CBD, it boasts an unparalleled panorama that includes Hyde Park, the majestic St Mary's Cathedral, and the sparkling Harbour. From its rooftop vantage point, you can gaze across the water, taking in the iconic Fort Denison and the Sydney Heads. Drenched in morning sunlight this open plan layout features living and dining with separate kitchen. The perfect investment or city pad.

- Light filled and airy interiors throughout
- Mesmerising views to the North-East
- Well-equipped kitchen, timber flooring
- Access to rooftop pool and viewing deck
- Convenient security building complex
- Steps to cafes, shops and restaurants
- 100m to Town Hall, Hyde Park & QVB

### Auction

Saturday, 01 Jun 2024, 10:00 am

### View

As advertised or by appointment

### Agents

#### Ettiene West

📞 0410 593 749

✉️ ettiene@morton.com.au

#### Arman Zounuzy

📞 0410 539 793

✉️ arman.zounuzy@morton.com.au

[morton.com.au](https://morton.com.au)

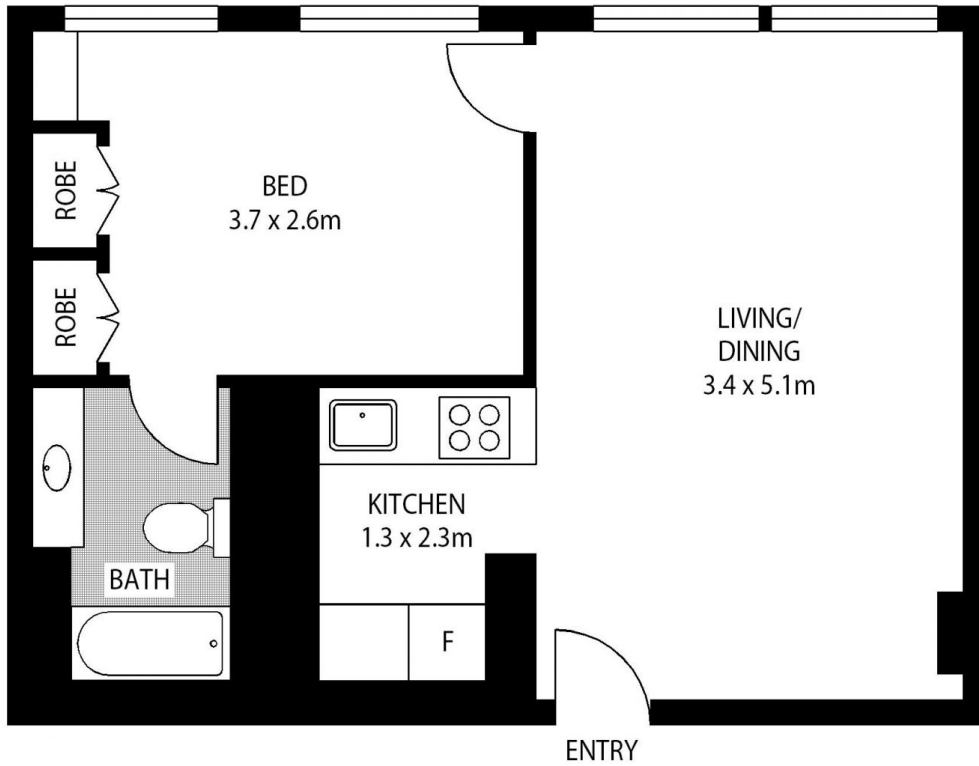

**LEVEL 21**



**215/27 PARK STREET**

**SYDNEY**

SCAPE Floor Planning Disclaimer: This floor plan is conceptual only. It is provided for illustrative purposes only and should not be relied upon. We make no guarantee as to the correctness of this plan. All interested parties should make and rely on their own enquiries in determining the accuracy of the information contained in this floor plan.